

REVISIONS			
REV	MOD	DESCRIPTION	DATE

TABLE FOR STANDARD IDLER ROLLERS

PART NUMBER	DIM A ROLLER DIAMETER ±.003	DIM B ROLLER WIDTH ±.010	DIM C BORE DIAMETER +.0005 +.0020	DIM D CORE DIAMETER ±.010
402-ZZ	3/8	3/8	1/8	1/4
404-ZZ	1/2	1/2	1/8	5/16
406-ZZ	1/2	1/2	3/16	5/16
408-ZZ	5/8	5/8	3/16	5/16
410-ZZ	5/8	5/8	1/4	3/8
412-ZZ	3/4	1/2	3/16	3/8
415-ZZ	3/4	1/2	1/4	7/16
418-ZZ	1	3/4	1/4	1/2
419-ZZ	1	1	1/4	1/2
420-ZZ	1	1/2	5/16	1/2
421-ZZ	1	3/4	5/16	1/2
422-ZZ	1	1	5/16	1/2

CROSS SECTIONAL VIEW
THROUGH CENTER LINE OF ROLLER

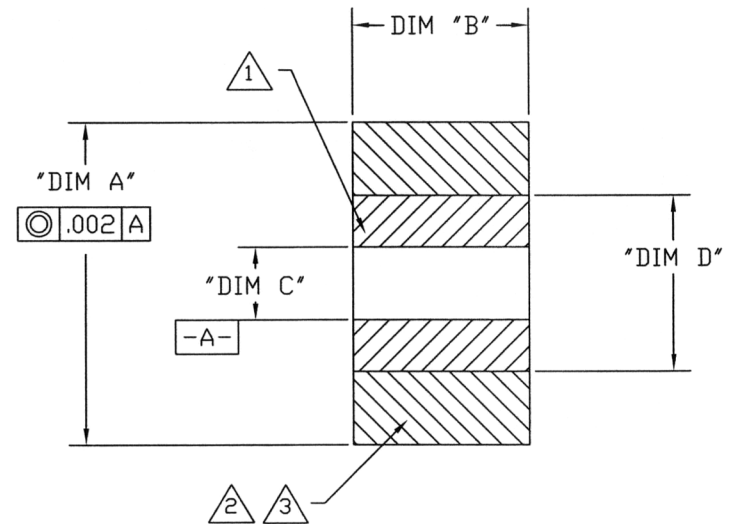

NOTES:

- 1 CORE - 841 SINTERED BRONZE SLEEVE BEARING, OIL IMPREGNATED
- 2 POLYURETHANE, POLYESTER: 55A BLUE OR 70A ORANGE
- 3 -ZZ PORTION OF PART NUMBER REFERS TO HARDNESS FOR 55A USE -55 & FOR 70A USE -70

TOLERANCES:	POLYDRIVE INDUSTRIES	
	MESA, ARIZONA	
	PART NO. SEE TABLE	REV A
	IDLER ROLLER, STANDARD	
UNLESS OTHERWISE SPECIFIED ALL DIMENSIONS ARE IN INCHES	SCALE: NONE	DATE: 11/30/01
	DRAWN BY: PM	
	MATERIAL: SEE ABOVE	